

Chevrolet / GMC Trucks/SUV's 1973-1991

KIT FEATURES

- 2-shaft radio provision
- DIN radio provision

KIT COMPONENTS

- A) Faceplate • B) DIN radio housing

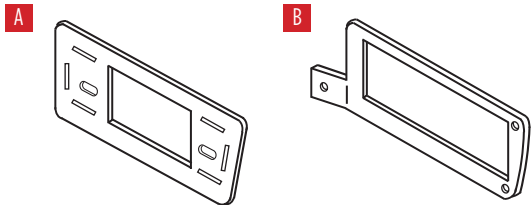

APPLICATIONS

Chevrolet			GMC				
Blazer	1973-1987	Kodiak C4500-C8500	1981-1990	C/K Pickup	1973-1987	R/V Pickup	1987-1991
C/K Pickup	1973-1987	Suburban	1973-1987	Jimmy	1978-1987	Suburban	1973-1987
				Kodiak	1981-1989		

TABLE OF CONTENTS

Dash Disassembly.....	2
Kit Assembly	
–2-shaft radio provision.....	4
–DIN radio provision.....	5

TOOLS REQUIRED

- Phillips screwdriver • Metal & plastic cutting tool
- Scribe tool

CAUTION! All accessories, switches, climate controls panels, and especially air bag indicator lights must be connected before cycling the ignition. Also, do not remove the factory radio with the key in the on position, or while the vehicle is running.

DASH DISASSEMBLY

1. Remove (4) Phillips screws securing the lower steering column panel, then remove the panel.
2. Remove (8) Phillips screws from the perimeter of the dash trim bezel, then remove the bezel.
3. Remove (3) Phillips screws securing the radio. Remove any objects behind the radio prohibiting it from being removed. Slide the radio out, then unplug and remove the radio.

Continue to Kit Assembly

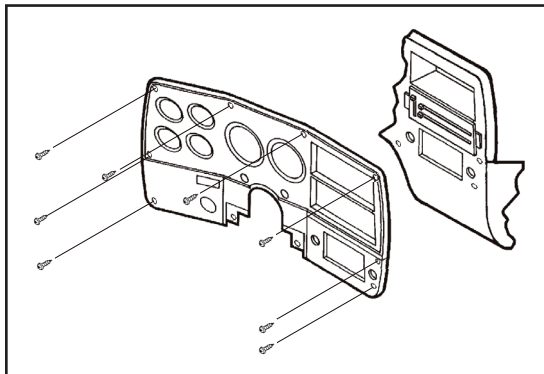

KIT ASSEMBLY

2-Shaft radio provision

1. Reinstall the factory trim bezel in reverse order of disassembly.
2. Position the *faceplate* against the face of the factory trim bezel, then slide it to the right until the right edge of the *faceplate* meets the lip of the bezel. (Fig. A)
3. Slide the radio through the sub-dash, dash trim bezel, then the *faceplate*. Secure the radio with the shaft nuts provided with the radio. (Fig. B)
4. Locate the factory wiring harness and antenna connector in the dash and complete all necessary connections to the radio. Metra recommends using the proper mating adapter from Metra. Test the radio for proper operation.
5. Reassemble the dash in reverse order of disassembly to complete the installation.

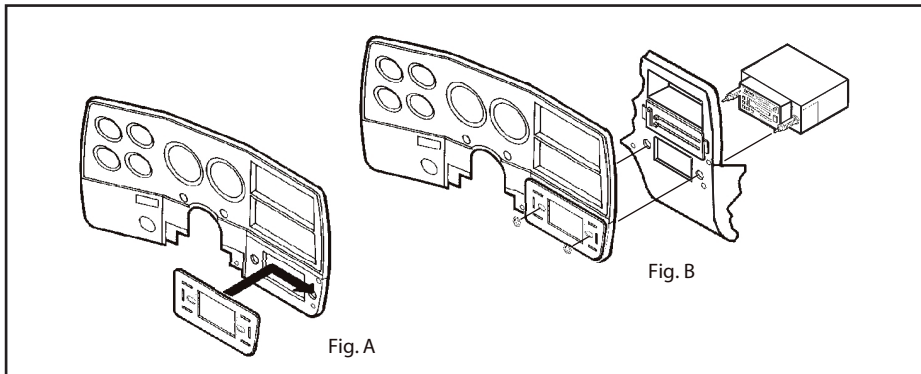

KIT ASSEMBLY

DIN radio provision

1. Temporarily secure the *DIN radio housing* to the sub-dash using the factory screws. (Fig. A)
2. Scribe the sub-dash metal on the inside of the *DIN radio housing*. (Fig. B)
3. Remove the *DIN radio housing*.
4. Cut the sub-dash along the scribed line.
5. Permanently secure the *DIN radio housing* to the sub-dash using the factory screws. (Fig. C)
6. Cut and remove the 2-shaft supports from the *faceplate*.
7. Reinstall the factory trim bezel in reverse order of disassembly.
8. Remove the metal DIN sleeve from the aftermarket radio.
9. Position the *faceplate* against the face of the factory trim bezel, then slide it to the right until the right edge of the *faceplate* meets the lip of the bezel. The DIN holes previously cut should line up. (Fig. D)
10. Slide the sleeve through the radio opening and secure by bending the metal locking tabs down, then slide the radio back into the sleeve until it clicks in. (Figure E)
11. Locate the factory wiring harness and antenna connector in the dash and complete all necessary connections to the radio. Metra recommends using the proper mating adapter from Metra. Test the radio for proper operation.
12. Reassemble the dash in reverse order of disassembly to complete the installation.

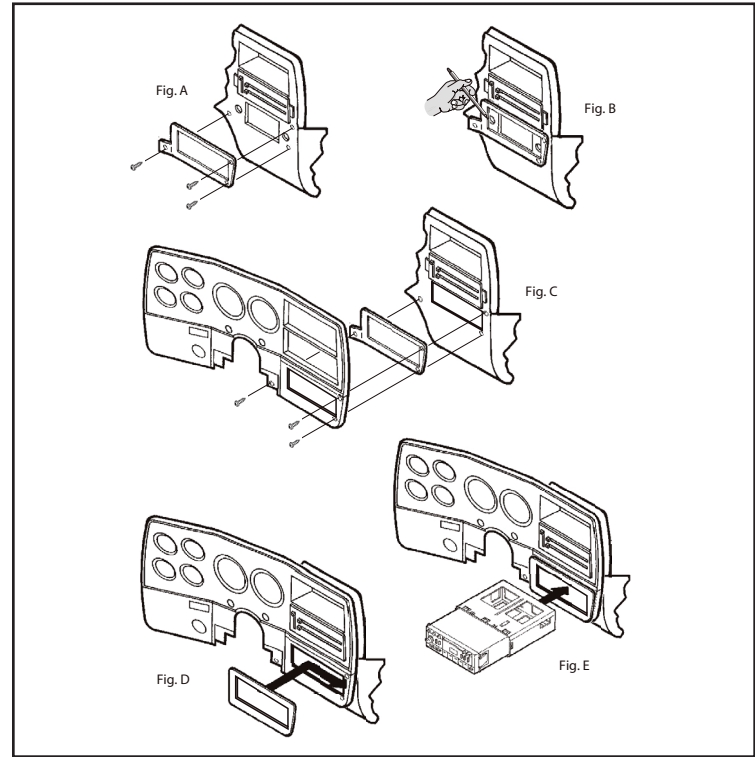



87-99-3052
INSTALLATION INSTRUCTIONS



IMPORTANT

If you are having difficulties with the installation of this product, please call our Tech Support line at 1-800-253-TECH. Before doing so, look over the instructions a second time, and make sure the installation was performed exactly as the instructions are stated. Please have the vehicle apart and ready to perform troubleshooting steps before calling.



KNOWLEDGE IS POWER

Enhance your installation and fabrication skills by enrolling in the most recognized and respected mobile electronics school in our industry. Log onto www.installerinstitute.com or call 800-354-6782 for more information and take steps toward a better tomorrow.



**Metra recommends MECP
certified technicians**